

REVISIONS						
ZONE	LTR	DESCRIPTION	CHANGE No	DATE	BY	APPR'D
	A	RELEASED FOR PRODUCTION	73231	09DEC10	SLK	CFH

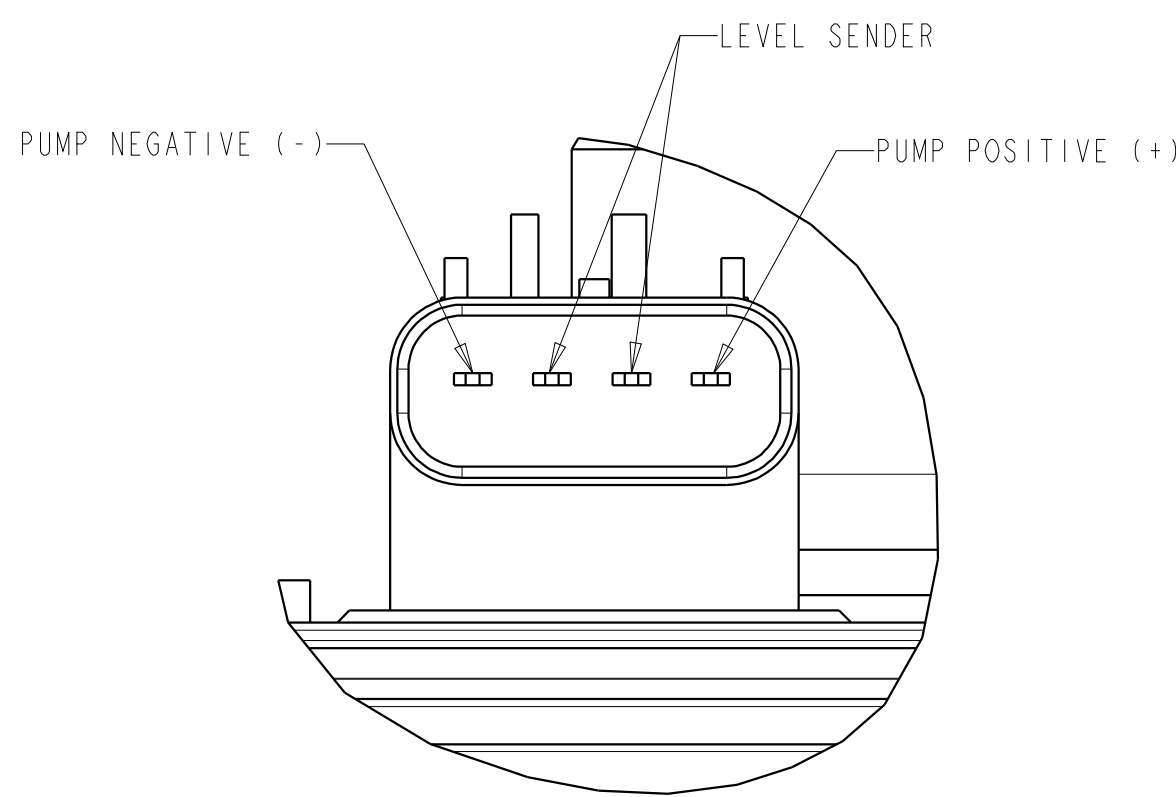

VIEW Z  
E-CONN PINNOUT  
SCALE 2:1

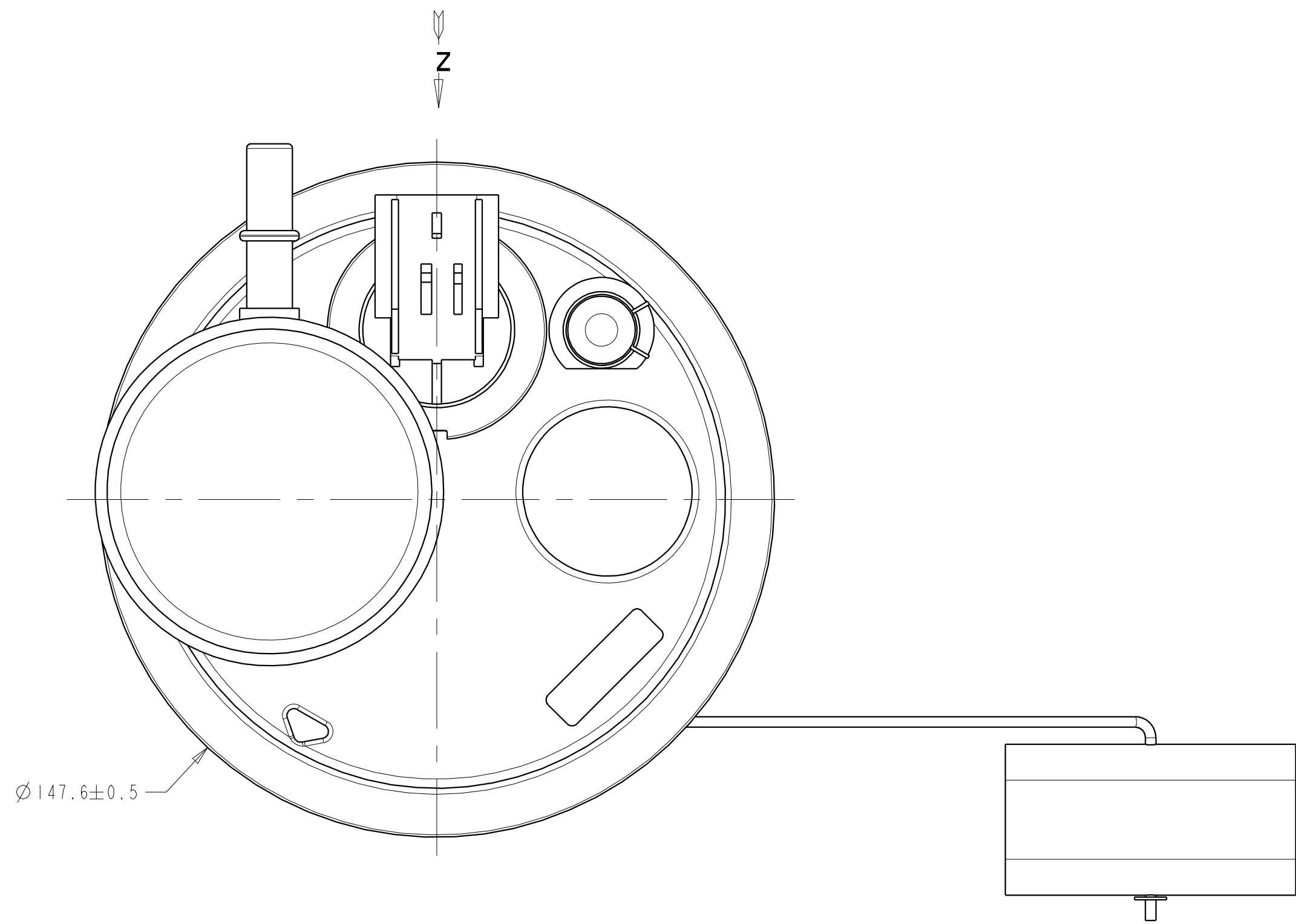
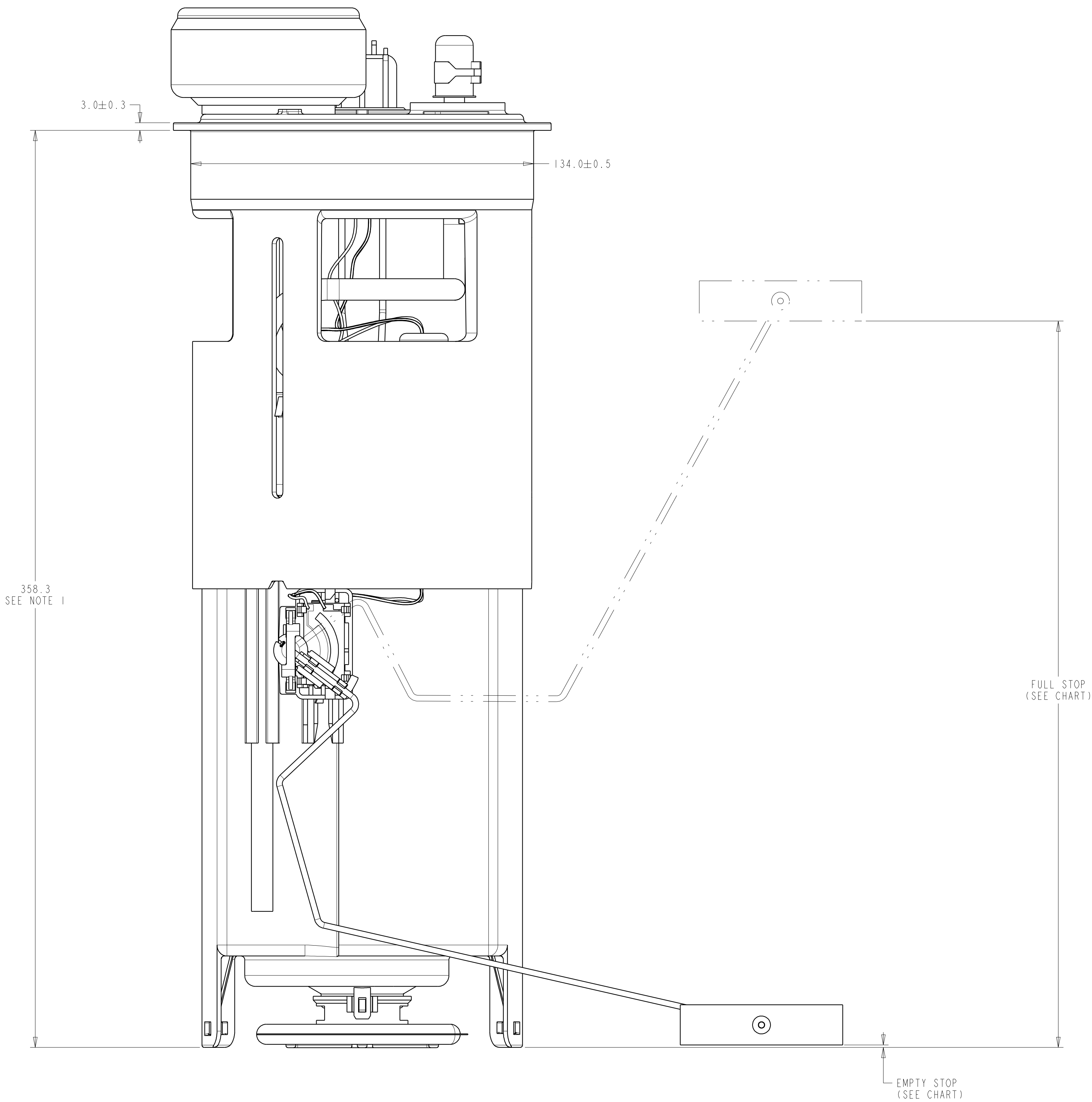

LEVEL SENDER CHART		
POINT	HEIGHT (MM)	RESISTANCE (OHMS)
FULL STOP	284.5	20±6
EMPTY STOP	0.0	220±6

NOTE:  
1. FUEL MODULE IS SHOWN IN INSTALLED POSITION.  
TRAVEL FROM THIS POSITION IS ±25mm.

THIS DRAWING IS THE PROPERTY OF TI AUTOMOTIVE. IT IS AUTOMATICALLY CONFIDENTIAL AND PROPRIETARY. IT IS NOT TO BE REPRODUCED OR TRANSMITTED IN ANY FORM OR BY ANY MEANS, ELECTRONIC OR MECHANICAL, INCLUDING PHOTOCOPYING, RECORDING, OR BY ANY INFORMATION STORAGE AND RETRIEVAL SYSTEM, WITHOUT THE WRITTEN PERMISSION OF TI AUTOMOTIVE. THIS DRAWING IS THE PROPERTY OF TI AUTOMOTIVE. IT IS AUTOMATICALLY CONFIDENTIAL AND PROPRIETARY. IT IS NOT TO BE REPRODUCED OR TRANSMITTED IN ANY FORM OR BY ANY MEANS, ELECTRONIC OR MECHANICAL, INCLUDING PHOTOCOPYING, RECORDING, OR BY ANY INFORMATION STORAGE AND RETRIEVAL SYSTEM, WITHOUT THE WRITTEN PERMISSION OF TI AUTOMOTIVE.

METRIC  
ALL DIMENSIONS ARE IN MILLIMETERS

DO NOT SCALE  
DECIMAL TOLERANCES UNLESS OTHERWISE SPECIFIED  
ONE PLACE ±0.25 TWO PLACE ±0.13 ANGLES ±1°

THIRD ANGLE PROJECTION  
DIMENSIONS IN ACCORDANCE WITH ASME Y14.5 - 2009

630 COLUMBIA ST.  
CARO, MI 48123  
+1 989.613.7727

ENGINEER	C.ROCKMAN	09DEC10	MATERIAL/SPECIFICATION
DES.MANAGER	S.RADY	09DEC10	
DESIGNER	S.RADY	09DEC10	

CAD SYSTEM: PROVE	SCALE: 1:1	SHEET NO. 1 OF 1
REFERENCE TO: FMD001186	PLW REFERENCE: 000105151/AA	
REFERENCE TO: CAD DWG: AR0029344/AA	CAD ASM: AR0029345/AA	

FUEL MODULE ASM - T300 98 S.C. AFTMKT  
STRT: A0  
DRAWING NO: TUI38